



## Bethany Villa

### Services & Fees as of August 1, 2024 Licensed Light to Intermediate Personal Care

<b>Cleaning:</b>	
• Garbage	Daily
• Regular Cleaning	Weekly
• Mess Clean-Up	Yes
<b>Linen/Laundry Service:</b>	
• Towels	Daily
• Laundry – Sheets	Yes
• Laundry – Personal	Yes
<b>Food Services:</b>	
• Meals	Yes
• a.m. and p.m. Snack	Yes
• Delivery of Night Snack	Yes
• Follow-up if absent at meal/night snack	Yes
• Assistance to Table if staffing permits	Yes
• Plate delivery to suite when sick (by staff)	Yes
<b>Personal Care:</b>	
• Dispense Medications from blister packs	Yes
• Fill Syringes	No
• Assist Insulin Tabs	Yes, if possible
• Assist Colostomy Care	Yes, if possible
• Assist Catheter Care	Yes, if possible
• Bandages	Yes, if possible
• Stockings	Yes, if possible
• Blood Tests	Yes
• Eye Drops & Patches	Yes
• Baths	Yes
• Dressing	Yes
<b>Supervision:</b>	
• Potential Emergency Response	Yes
• First Contact if resident has installed a monitored security device	Yes
• Night Check – Hourly	Yes
<b>Other Individual Needs:</b>	Discretionary, and may require additional cost

*Cleaning:*

- Regular cleaning includes periodic cleaning of mini-fridge and windows.

*Food Services:*

- Personal Care snacks will be available morning and afternoon in the Personal Care Activities Room fridge.
- Evening snack will be delivered to the suites (along with medications).

*Personal Care:*

- Staff will assist with insulin tabs, colostomy care, catheter care, and specialty stockings only if it has been deemed appropriate by a nurse and training has taken place.
- Staff will assist with bandages only if the wound doesn't require nursing care.
- Shampoo, toothpaste, soap, Kleenex, and toilet paper will be provided.
- Bathroom towels will be provided.
- "Depends" and other continence supplies will not be provided.
- Personal care services will be provided only in Bethany Villa.

*Supervision:*

- Resident Aide must be informed when resident is leaving the home, even for short periods, especially when medications are required in the resident's care.

***Personal Care Fee Chart:***

Single Occupancy in a Single Unit	\$	4,367.00
Single Occupancy in a Double Unit	\$	4,405.00
Single Occupancy in Single Plus unit #615	\$	4,386.00

**Double occupancy** can be available, and fees for a couple will be adjusted to factor in the additional services and meals required by a couple.

"Single Units" are 388 sq. ft. + 70 sq. ft. indoor patio

"Single Plus" Unit #615 is 450 sq. ft. + 84 sq. ft. indoor patio

"Double Units" are 510 sq. ft. + 84 sq. ft. indoor patio

"Single Units" are large enough to house couples.

"Single Plus Unit" large enough to house a couple.

"Double Units" are prioritized for couples.

**Marianne Hamm, Personal Care Home  
& Resident Services Manager**

**Cell:** 306-229-6356

**Fax:** 306-242-9047

**Email:** marianneh@b55.ca

**Janina Chamberlain,  
Housing Officer**

**Office:** 306-242-9101

**Fax:** 306-242-9047

**Email:** janina@b55.ca

**EXAMPLE of a Bethany Villa Licensed Personal Care Suite (Single)**

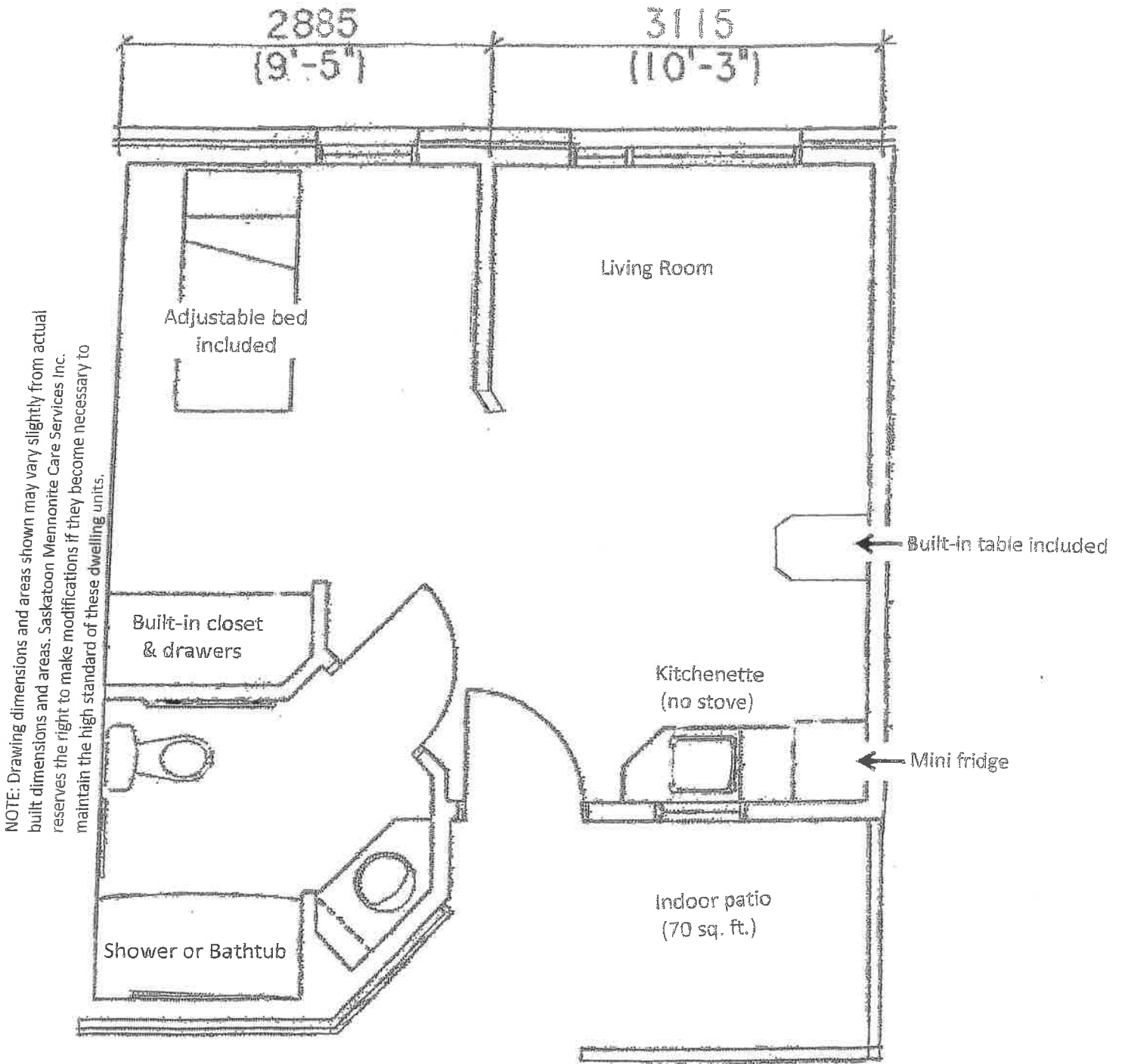

*Included in suite: adjustable bed, built-in cabinetry/wall unit in bedroom, small attached table in kitchenette, mini fridge in kitchenette, garbage can*

- Suites are approximately 388 sq. ft.
- Includes an indoor patio that is approximately 70 sq. ft.
- Units face either North or South.