



Bethany Place & Bethany Villa

Assisted Living and/or Personal Care Accommodation for Seniors
operated by SASKATOON MENNONITE CARE SERVICES INC.

110 La Ronge Road, Saskatoon SK S7K 7H8

phone: 306-242-9019 fax: 306-242-9047 email: info@bethany55plusliving.ca

website: www.bethany55plusliving.ca

Applicant's Name _____ **Date of Birth** ____/____/____
Day / Month / Year

Address _____

Postal Code _____ **Telephone #** _____

Co-Applicant's Name _____ **Date of Birth** ____/____/____
Day / Month / Year

Relationship to Applicant _____

Address _____

Postal Code _____ **Telephone #** _____

Do you have a Church affiliation? (optional) (This information may assist our onsite Spiritual Care Coordinator.)

Church Name _____ **Phone #** _____

Alternate Contacts for Applicant/Co-Applicant:

I/We, Applicant/Co-Applicant, hereby give consent for Saskatoon Mennonite Care Services Inc. to contact the people noted below and to discuss the details of my/our application with them in the event I/We cannot be reached, or in the event the contact person requests information from Saskatoon Mennonite Care Services Inc. on my/our behalf.

Applicant Initials

Co-Applicant Initials

Family Contact:

Name _____

Address (incl. _____

postal code) _____

Email Address _____

Home Phone # _____

Work # _____ **Cell #** _____

Relationship to Applicant _____

Power of Attorney:

Name _____

Address (incl. _____

postal code) _____

Email Address _____

Home Phone # _____

Work # _____ **Cell #** _____

Relationship to Applicant _____

I am / We are Applying For:

Bethany Place Assisted Living: Rental and/or Life Lease

and/or Bethany Villa Personal Care (Rental only)

I/We understand that acceptance of this application does not constitute an agreement by Saskatoon Mennonite Care Services Inc. to provide accommodation. I/We acknowledge that this application becomes the property of Bethany upon delivery and that it will be treated with confidence.

I/We have read and understand the Bethany Place Assisted Living GUIDELINES FOR RESIDENTS & FAMILIES OF BETHANY PLACE (Schedule B) and PERSONAL ASSISTANCE PROGRAM OUTLINE (Schedule C).

I/We have read and understand the Bethany Villa Personal Care “Services – Licensed Light to Intermediate Personal Care” summary of services and fees.

Should this application be accepted, I/We hereby undertake to ensure that the terms as set forth in the life lease or rental agreement will be strictly carried out and that all fees will be promptly paid.

I/We understand that evidence of income will be required at time of admission for **Bethany Place** Assisted Living.

Fees are set by the Board of Directors. Applicants are contacted in the order applications are received. Bethany reserves the right to determine the applicant’s suitability for Assisted Living or Personal Care during the application process.

I/We understand that Bethany is a non-smoking and scent-free facility and that no pets are permitted.

I/We hereby authorize Saskatoon Mennonite Care Services Inc. to make any inquiries they deem necessary to verify the applicant’s/co-applicant’s suitability for Assisted Living/Personal Care.

Date _____ Applicant Signature _____
day month year

Co-Applicant Signature _____

Witness _____
Family Member or Power of Attorney
(Signature and printed name)

.....
FOR OFFICE USE ONLY

Date & Time Original Application Received _____

Application Update _____

Application Update _____

Application Update _____

Application Update _____

Application Update _____

Application Update _____

Application Update _____

Application Update _____



Bethany Villa

Services & Fees as of August 1, 2024 Licensed Light to Intermediate Personal Care

Cleaning:	
• Garbage	Daily
• Regular Cleaning	Weekly
• Mess Clean-Up	Yes
Linen/Laundry Service:	
• Towels	Daily
• Laundry – Sheets	Yes
• Laundry – Personal	Yes
Food Services:	
• Meals	Yes
• a.m. and p.m. Snack	Yes
• Delivery of Night Snack	Yes
• Follow-up if absent at meal/night snack	Yes
• Assistance to Table if staffing permits	Yes
• Plate delivery to suite when sick (by staff)	Yes
Personal Care:	
• Dispense Medications from blister packs	Yes
• Fill Syringes	No
• Assist Insulin Tabs	Yes, if possible
• Assist Colostomy Care	Yes, if possible
• Assist Catheter Care	Yes, if possible
• Bandages	Yes, if possible
• Stockings	Yes, if possible
• Blood Tests	Yes
• Eye Drops & Patches	Yes
• Baths	Yes
• Dressing	Yes
Supervision:	
• Potential Emergency Response	Yes
• First Contact if resident has installed a monitored security device	Yes
• Night Check – Hourly	Yes
Other Individual Needs:	Discretionary, and may require additional cost

Cleaning:

- Regular cleaning includes periodic cleaning of mini-fridge and windows.

Food Services:

- Personal Care snacks will be available morning and afternoon in the Personal Care Activities Room fridge.
- Evening snack will be delivered to the suites (along with medications).

Personal Care:

- Staff will assist with insulin tabs, colostomy care, catheter care, and specialty stockings only if it has been deemed appropriate by a nurse and training has taken place.
- Staff will assist with bandages only if the wound doesn't require nursing care.
- Shampoo, toothpaste, soap, Kleenex, and toilet paper will be provided.
- Bathroom towels will be provided.
- "Depends" and other continence supplies will not be provided.
- Personal care services will be provided only in Bethany Villa.

Supervision:

- Resident Aide must be informed when resident is leaving the home, even for short periods, especially when medications are required in the resident's care.

Personal Care Fee Chart:

Single Occupancy in a Single Unit	\$	4,367.00
Single Occupancy in a Double Unit	\$	4,405.00
Single Occupancy in Single Plus unit #615	\$	4,386.00

Double Occupancy can be available, and fees for a couple will be adjusted to factor in the additional services and meals required by a couple.

"Single Units" are 388 sq. ft. + 70 sq. ft. indoor patio

"Single Plus" Unit #615 is 450 sq. ft. + 84 sq. ft. indoor patio

"Double Units" are 510 sq. ft. + 84 sq. ft. indoor patio

"Single Units" are large enough to house couples.

"Single Plus Unit" large enough to house a couple.

"Double Units" are prioritized for couples.

**Marianne Hamm, Personal Care Home
& Resident Services Manager**

Cell: 306-229-6356

Fax: 306-242-9047

Email: marianneh@b55.ca

**Janina Chamberlain,
Housing Officer**

Office: 306-242-9101

Fax: 306-242-9047

Email: janina@b55.ca

EXAMPLE of a Bethany Villa Licensed Personal Care Suite

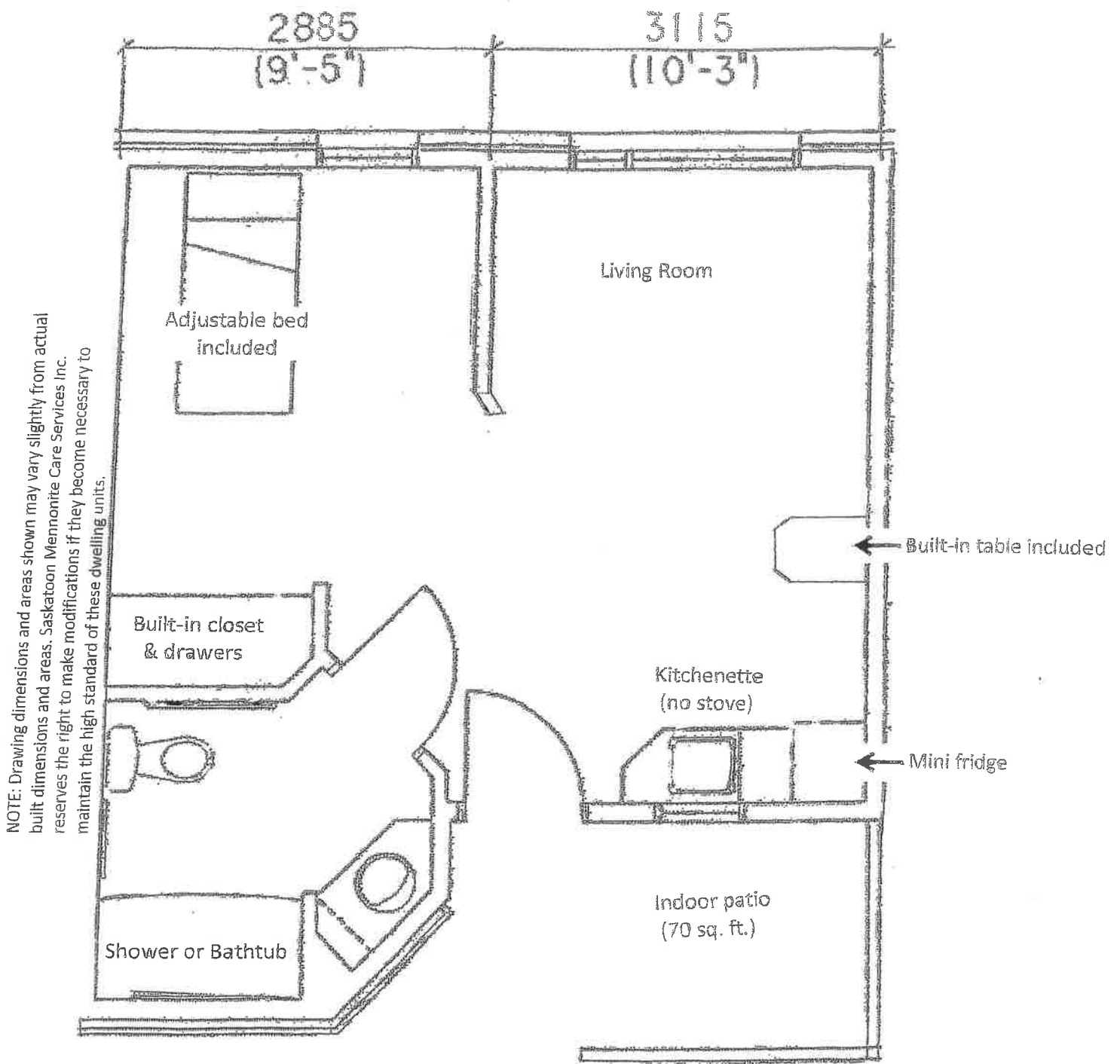

Included in suite: adjustable bed, built-in cabinetry/wall unit in bedroom, small attached table in kitchenette, mini fridge in kitchenette, garbage can

- Suites are approximately 388 sq. ft.
- Includes an indoor patio that is approximately 70 sq. ft.
- Units face either North or South.